

# Focus



## Focus # 398 on Willen & Willen Park

9 issues a year since 1979, not just at election time.  
Written by Kerrie Bradburn, printed on recyclable paper & distributed by volunteers.

## MK East Starting soon

The residents' group who meet regularly with developers Berkeley St James had their third meeting last month with a fourth being arranged for January.

For a copy of the slides presented at the meeting and the action note, email or text Kerrie on:

[focusteam@live.co.uk](mailto:focusteam@live.co.uk)  
07803 036 656

Work to remove the trees on the Willen side of the V11 Tongwell Street will start, possibly in December but more likely January, and must be finished by end-February when the nesting season starts. Meanwhile there are ongoing discussions about how many trees must actually be removed.

Chillery Leys residents have won an undertaking that a visual barrier will be provided to protect their privacy during the works.

Looking ahead Berkeley St James have confirmed that they have pencilled in **Wednesday 22 March** next year for the permanent closure of Carleton Gate. However this remains a provisional date pending approval of their overall project schedule.

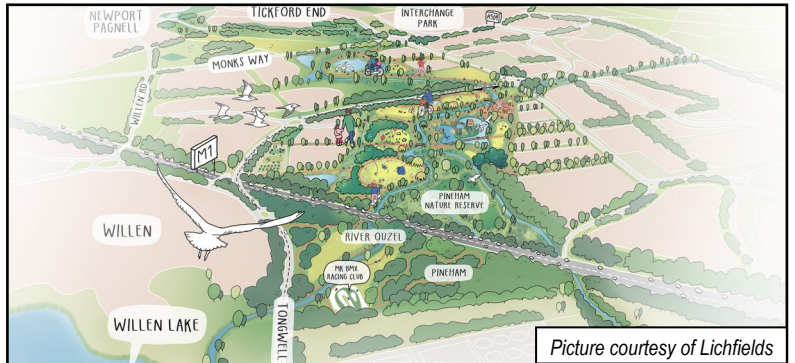

Picture courtesy of Lichfields

## Christmas at St Mary Magdalene

### Sunday 18 December

**5 pm** Carol service, with the choir Quorum

### Saturday 24 December, Christmas Eve

**3 pm** Children's service

Theme: The Coming of the Light (featuring stars)

**11.30 pm** Midnight Communion

### Sunday 25 December

**9.30 am** Christmas Day Communion



Possible closure from  
22 March next year

## Cost of living crisis

The Council has published advice on sources of help during the crisis. You'll find it here:

<https://www.milton-keynes.gov.uk/benefits/cost-living->

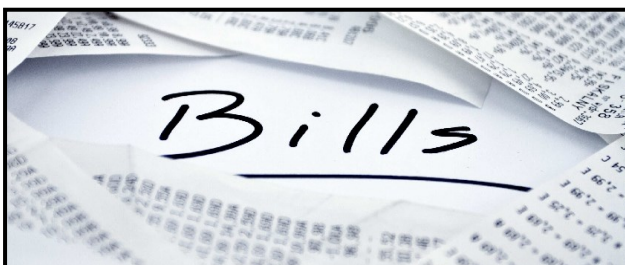

# The Lib Dem **Focus** Team

## Working & keeping in touch all year round

## Focus 399 goes digital

Our next edition of **Focus** is going to be published **solely online and via email**. If you like keeping up to date with the latest community news join our mailing list so you don't miss out on our updates. Here's the link: <https://focusteamlive.co.uk/en/subscribe-by-email>

or scan the QR code:



If you'd still like to receive a paper copy please email, phone or text us at:

[focusteam@live.co.uk](mailto:focusteam@live.co.uk) 07803 036 656



Do you think there are areas in Willen and Willen Park that should be subject to a **20 mph speed-limit**?

Provided 70% of residents in a given area agree, the Council can introduce these limits once a petition has been received confirming resident support.

Nominate your road and we'll set up the petition. Let us know on:

[focusteam@live.co.uk](mailto:focusteam@live.co.uk) 07803 036 656

## School admissions

The Council is consulting on planned admission numbers from September 2024. It's proposed to reduce Willen Primary's numbers from 60 to 30.

What do **YOU** think? Here's the link to the consultation:

<https://www.milton-keynes.gov.uk/consultations/school-admission-arrangements-september-2024>

The deadline to respond is **Saturday 18 December**.



## Kerrie, Uroy & Sam

### The Lib Dem **Focus** team

We aim to reply to mails, text or calls within 48 hours. Texting's usually fastest. If we don't, please get in touch again in case we've missed your message.

**Thank you !**

# Stronger Economy, Fairer Society

## Opportunity for Everyone